

Climbing triangle tunnel

Ref.JIK4007S

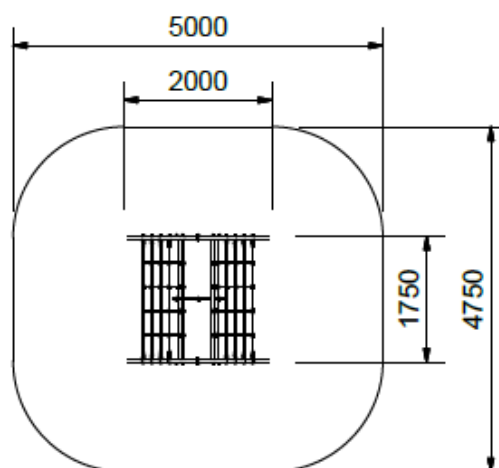
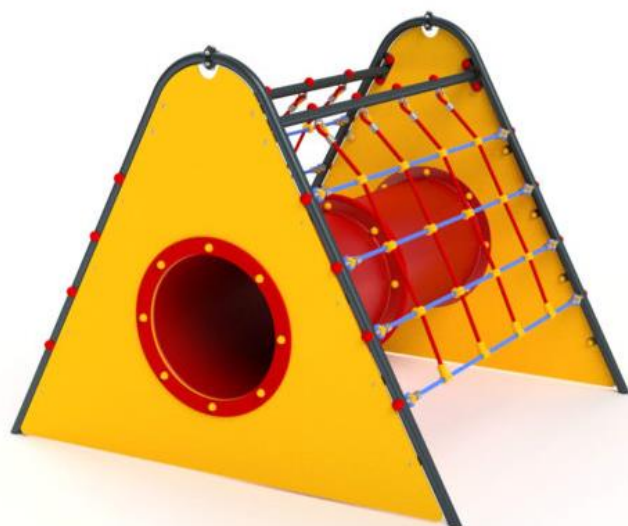

Specifications

- Triangular structure with climbing nets and a tunnel.
- Powder coated galvanized steel construction.
- Decorative panels made of HDPE plates.
- Stainless and galvanized steel connectors.
- Powder-coated galvanized steel metal elements.
- Polypropylene ropes with steel core. With aluminum and polyamide connectors.
- No sharp edges or cracks that could pose the head entrapment, fingers or any other part of the body.
- All screws covered with polyamide caps.
- Its anchorage 800 mm on the ground is recommended.
- Recommended age of use from 3 years.
- The device is designed for outdoor installation.
- Certified according to UNE EN1176 regulations.